

Garden Path

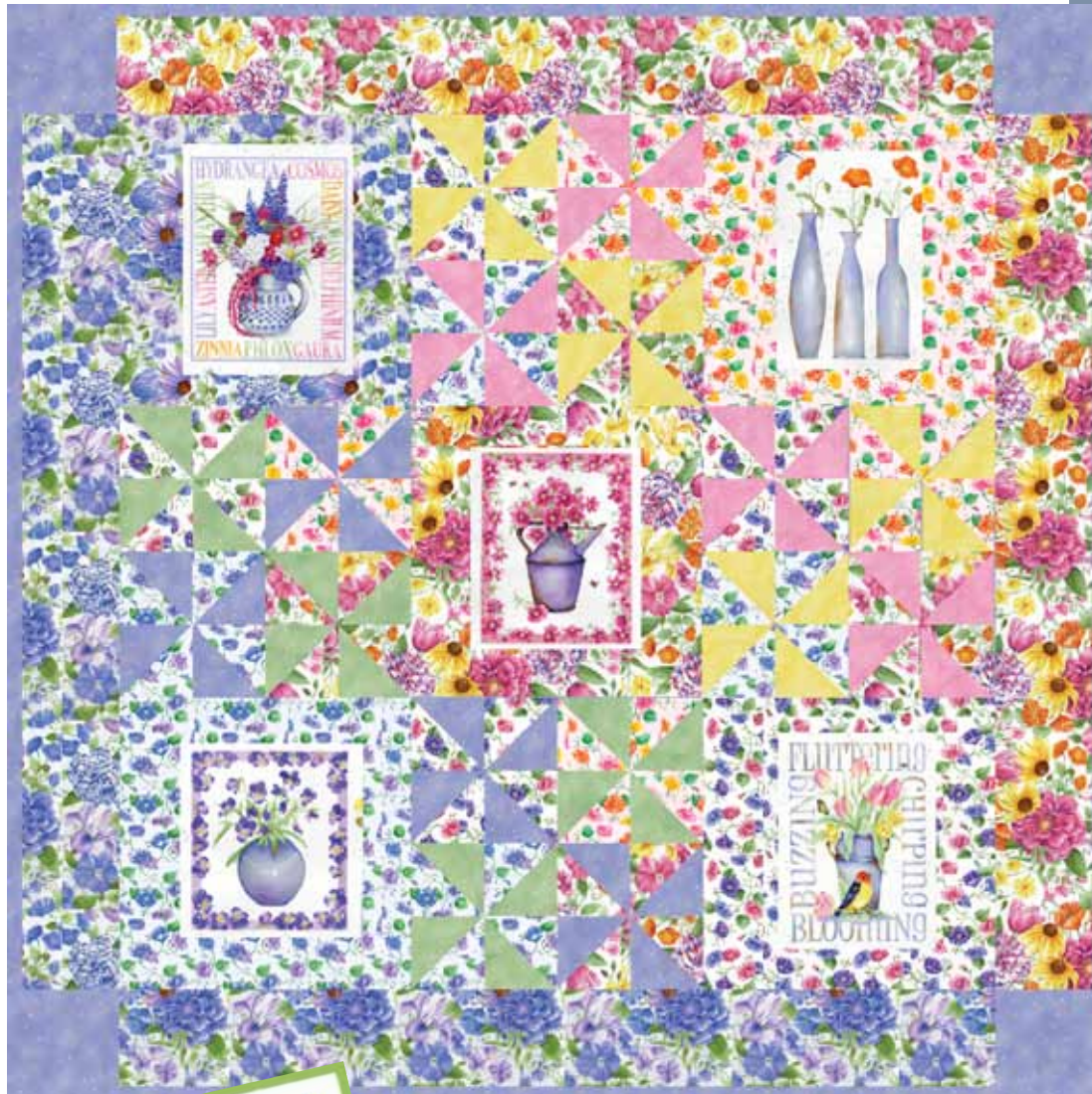

pattern tested

Featuring fabrics from the
Garden Path
collection by Barb Tourtillotte
Finished size: 44-1/2" x 44-1/2"
Design by September Olson for Clothworks



www.clothworkstextiles.com

info@clothworkstextiles.com

Materials

Yardages based on 42" wide fabric

Materials:

- 1 Panel (Y0386-1)
- 1/2 yd Blue Lg Floral (Y0388-29)
- 5/8 yd Pink Lg Floral (Y0388-42)
- 3/8 yd White Sm Floral (Y0389-1)
- 3/8 yd Blue Sm Floral (Y0389-29)
- 3/8 yd Pink Sm Floral (Y0389-41)
- 1/4 yd Yellow Tonal (Y0385-8)
- 1/4 yd Green Tonal (Y0385-20)
- 3/4 yd Blue Tonal (Y0385-29) (includes binding)
- 1/4 yd Pink Tonal (Y0385-42)
- 1/4 yd Soft White Solid (not in group)
- 2-1/4 yds Backing of choice

Cut the Fabrics

WOF = Width of Fabric

LOF = Length of Fabric

From the Panel cut:

Fussy cut five rectangles of selected images 1/4" outside the image on all sides –see colored image of quilt

From the Blue Lg Floral cut:

- 2 – 4-1/2" x WOF strips (border)
- 1 – 4" x WOF strip (framing)

From the Pink Lg Floral cut:

- 2 – 4-1/2" x WOF strips (border)
- 1 – 4" x WOF strip (framing)
- 8 – 3-7/8" squares

From the White Sm Floral cut:

- 1 – 4" x WOF strip (framing)
- 8 – 3-7/8" squares

From the Blue Sm Floral cut:

- 1 – 4" x WOF strip (framing)
- 8 – 3-7/8" squares

From the Pink Sm Floral cut:

- 1 – 4" x WOF strip (framing)
- 8 – 3-7/8" squares

From the Yellow Tonal cut:

- 8 – 3-7/8" squares

From the Green Tonal cut:

- 8 – 3-7/8" squares

From the Blue Tonal cut:

- 8 – 3-7/8" squares
- 4 – 4-1/2" squares for corners (outer border)
- 5 – 2-1/2" x WOF strips for binding

From the Pink Tonal cut:

- 8 – 3-7/8" squares

From the Soft White Solid cut:

- 5 – 1" x WOF framing strips

Prior to starting this project, please check our web site for any updates to this pattern: www.clothworkstextiles.com

Directions

Frame the Panel images:

1. Measure the width of a rectangle from the Panel. Trim two White 1" framing strips to this measurement. Sew to the top and bottom edges of the rectangle. Press out toward the strips.
2. Measure the new height of the rectangle. Trim two White 1" framing strips to this measurement. Sew to the side edges of the rectangle. Press out toward the strips.
3. Measure the new width of the rectangle. Trim two strips from the appropriate 4" framing strip to this measurement (refer to quilt image). Sew to the top and bottom edges of the rectangle. Press out toward the strips. Centering the image, trim the rectangle to measure 12-1/2" in height.
4. Cut two 4" x 12-1/2" rectangles from the 4" framing strip. Sew to the side edges of the rectangle. Press out toward the strips. Centering the image, trim the rectangle to measure 12-1/2" in width. This should now be a 12-1/2" square.
5. Repeat Steps 1 through 4 with the remaining framing strips and rectangles from the Panel for a total of five 12-1/2" square framed images.

Make the Pinwheel Blocks:

1. On the reverse side of a White Sm Floral 3-7/8" square, pencil a diagonal line from corner to corner. Place right sides together with a Yellow Tonal 3-7/8" square. Sew 1/4" away from the line on both sides of the line (Figure 1). Cut on the pencil line and press the two squares open. Repeat to make two more squares for a total of four squares. They should measure 3-1/2".
2. Sew these four squares into a pinwheel block (Figure 2), measuring 6-1/2" square.
3. Repeat Steps 1 and 2 to make a total of four pinwheel blocks from the White Sm Floral 3-7/8" squares and the Pink, Blue, Green and Yellow Tonal 3-7/8" squares.
4. Repeat Steps 1 through 3 substituting Blue Sm Floral, Pink Large Floral and Pink Sm Floral 3-7/8" squares for the White Sm Floral, for a total of four pinwheel blocks from each fabric, for a total of sixteen pinwheel blocks altogether.
5. Referring to the quilt image for placement, sew four of the pinwheel blocks together to make a large block measuring 12-1/2" square (Figure 3). Repeat to make a total of 4 large blocks.

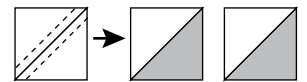

Figure 1

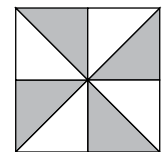

Figure 2

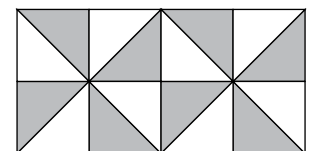
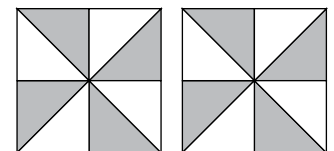

Figure 3

Assemble the quilt top:

1. Arrange the five Panel image squares and four large Pinwheel blocks in a nine-patch arrangement- see quilt image for placement.
2. Sew the blocks together in rows of three blocks. Press. Sew the rows together to complete the quilt center. Press.
3. Measure the height of the quilt center and trim four 4-1/2" strips - two each from the Blue Lg Floral and Pink Lg Floral - to this measurement. Following the quilt image, sew one of each color to the left and right sides of the quilt center. Press.
4. Sew a 4-1/2" Blue Tonal square to each end of the two remaining strips. Press. Sew to the top and bottom of the quilt center.
5. Layer with batting and backing and quilt as desired. Bind and label to finish.

While every attempt has been made to give accurate measurements, yardage requirements, and construction directions, this does not allow for personal variations in measuring, cutting and/or sewing. Clothworks is not responsible for printing errors.